

USP80-ER11(16)-F Ultrasonic Spindle Motor

Pneumatic Valve :

1. Use pressure : 0.6 ~1.0 bar
2. Function : to make the processing of the residual cut will not affect the efficiency of the tool .

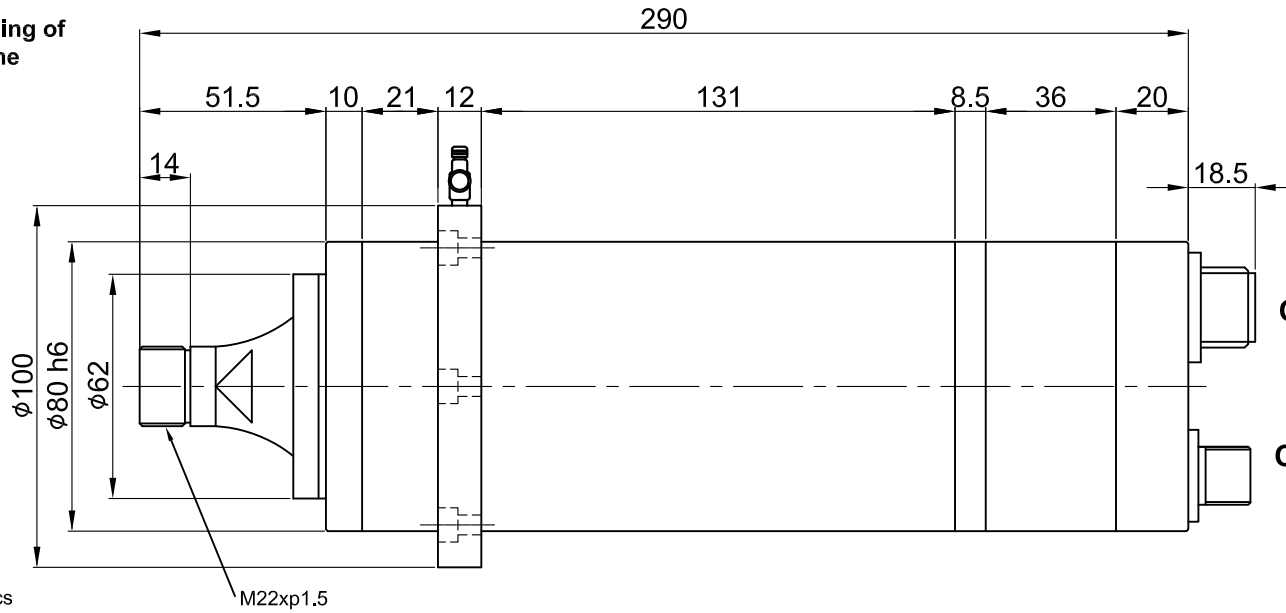
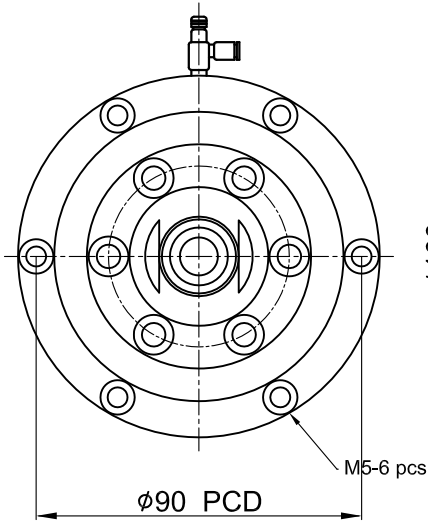

pinA-U pinD-Ground
pinB-V pinE-KTY
pinC-W pinF-KTY

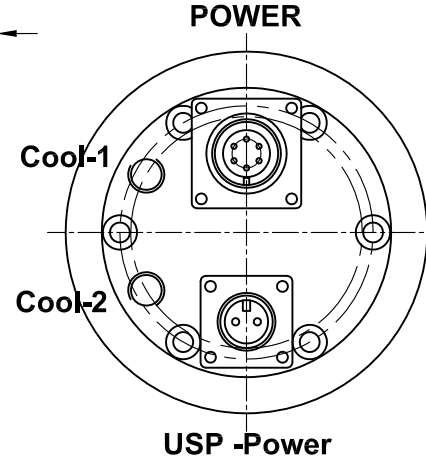

Ultrasonic connect :
pin1,A- (+)
pin2,B- (-)

Ultrasonic Spindle Motor Connector

Welding Surface

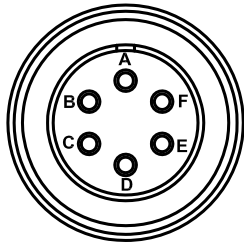

Motor Power Wire : Pin (A , B , C)

Ground Wire : Pin D

KTY (Control motor temperature) : Pin (E , F)

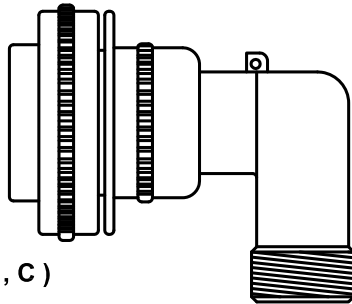

Open the machine every day,
so that the speed of the spindle 0~6000 rpm about 10minutes, slowly accelerated.
The bearing slowly heating, so that the life of the spindle will be longer

The manufacturer has the power to change the performance and appearance dimensions.
The change is made to the advanced method of the product.